

CLIPSO® EXCELLIUM 100 GALVANIZED TRAY PNEUMATIC WHEEL

Use

Wheelbarrow designed for heavy duties.
Loading capacity 200 kg.

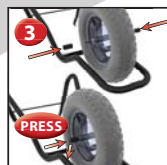
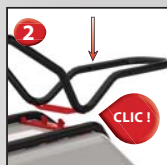

Product advantages

For the distributor :

Save place for storage and presentation. Palletised with the CLIPSO® concept for easy handling.

For the user :

Pre-assembled wheelbarrow, easy to assemble in less than 1 minute without tools !

Patented model very resistant, equipped with a strengthened frame and a ribbed tray.

Best for heavy duties, building and renovation, thanks to its galvanized tray treated anti-corrosion.

Bi-material handgrips. Pneumatic wheel to enhance comfort.

Technical data

CLIPSO® EXCELLIUM 100 GALVANIZED TRAY PNEUMATIC WHEEL (4079 G)

Tray	Galvanized 100 l, 1 mm thickness, treated anti-corrosion. Frontal and lateral ribs for additional strength.	Sizes	1450 x 680 x 585 mm.
Frame	Ø 32 mm black painted with integrated tipping bar and all round tubular support.	Weight	12,8 kg.
Wheel	Pneumatic Ø 400 mm, metal disc rim, long lasting notched tyre. Maximum pressure : 2 bars.	Spare parts	Wheel PF 154 Code : 309016701 EAN : 315503090167 8 Galvanized tray 100 l. Code : 309064101 EAN : 315503090641 3
		Packaging and codes	Pre-assembled x 18 : 308201701 EAN : 315503080203 6

