

CLIPSO® EXCELLIUM 100 TWIN GALVANIZED TRAY PNEUMATIC WHEELS

Use

Wheelbarrow designed for heavy duties.
Loading capacity 150 kg.

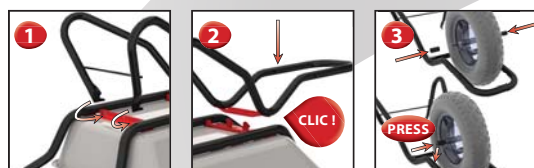

Product advantages

For the distributor :

Save place for storage and presentation. Palletised with the CLIPSO® concept for easy handling.

For the user :

Pre-assembled wheelbarrow, easy to assemble in less than 1 minute without tools !

Patented model very resistant, designed for an optimal ergonomics and balance.

Best for heavy duties, building and renovation, thanks to its galvanized tray treated anti-corrosion.

Bi-material handgrips. Pneumatic wheel to enhance the comfort in use.

Technical data

CLIPSO® EXCELLIUM 100 TWIN GALV. TRAY PNEUMATIC WHEELS (4090 G)

Tray	Galvanized 100 l, 1 mm thickness, treated anti-corrosion. Frontal and lateral ribs for additional strength.	Sizes	1270 x 765 x 585 mm.
Frame	Ø 32 mm black painted with integrated tipping bar and all round tubular support.	Weight	16,5 kg.
Wheels	Pneumatic Ø 380 mm, metal disc rims, long lasting notched tyres. Maximum pressure : 2 bars.	Spare parts	Wheel PF 150 Code : 309051401 EAN : 315503090514 0 Galvanized tray 100 l. Code : 309064101 EAN : 315503090641 3
		Packaging and codes	Pre-assembled x 14 : 308204201 EAN : 315503080250 0

